

Grandview®

Installation Guide for Large stage series super mobile screen

Grandview®

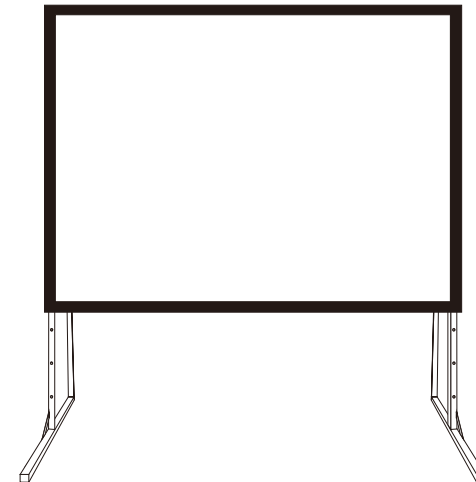

Model: LS-Exx

Grandview Crystal Screen Canada Ltd.

#11- 3751 North Fraser Way,
Marine Way Business Centre,
Burnaby, BC, Canada V5J 5G4
Tel:1-604-412-9777 Fax:1-604-412-9796
Website: www.grandviewscreen.ca

Guangzhou Grandview Crystal Screen Co., Ltd.

No.43 South International Trade Avenue, Hualong Town, Panyu,
Guangzhou, Guangdong, China
Tel:+8620-8489-9499 Fax:+8620-8480-3343
Website: www.grandviewscreen.com
www.grandviewscreen.com.cn



Thank you for purchasing a Grandview projection screen.

Before use, please read instructions carefully. After installation, keep instructions for future reference.

Description

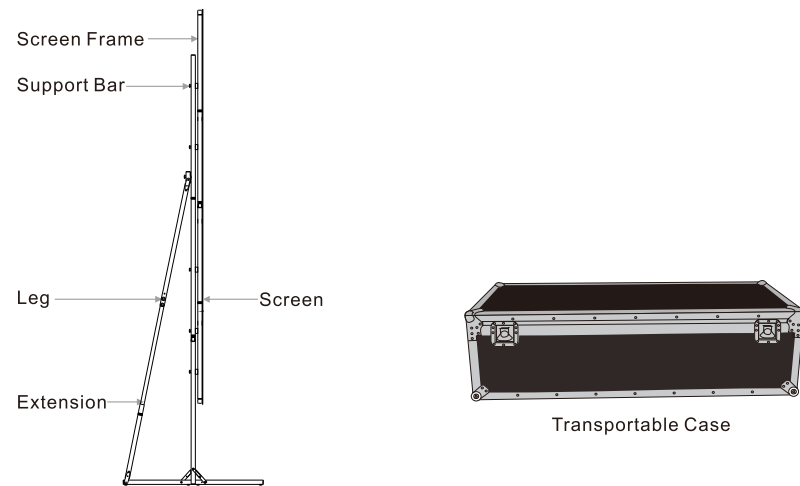

Accessories

■ Screen Frame (1pc)

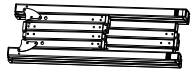

■ Legs (2pcs)



■ Tightening knobs



■ Fabric Package Bag (1pc)



■ White screen(1pc)



■ Gray screen (Optional)



■ Instruction Manual (1pc)

Accessories List

Specification(in)		100	120、150、180、200、250
Name	Unit	Qty	Qty
Screw Bar	Pcs	14	12

Sizes and specifications are subject to change at anytime.

Frame Specifications

Model	Sizes	Application
Large-Stage Super Mobile series	40mmx40mm	Applies up to 250" Large Stage Super Mobile screens

Sizes and specifications are subject to change at anytime.

Warnings

- Please read the following as any damage to the screen surface will affect the quality of the picture:
 1. Avoid contact or touching the screen surface as it may cause scratches or tears.
 2. Do not write or draw on the surface
 3. Clean the screen with a soft cloth and lukewarm water. Do not use any detergent or cleaning products.
- To avoid injury, two people are necessary for both assembly and storage.
- Please use in a location shielded from the elements, especially wind. A strong wind may cause the screen to fall. All pieces of the frame and stand must be used together. The screen can be used separately.
- To prevent unnecessary damage, the operating and maintenance of the screen should be done by adults.
- Please fold up screen and return all parts into the case after every use.



Ignoring the safety warnings may lead to injuries and/or damaging the product.



Store back into transporting case after use



Avoid conditions such as wind and rain when used outside

Do not take apart and replace with unknown parts. If there are any problems, please contact your local dealer. Product specifications are subject to change.

Installation

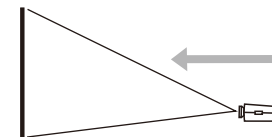

Picture 1

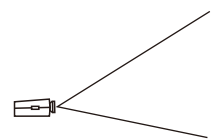

Picture 2

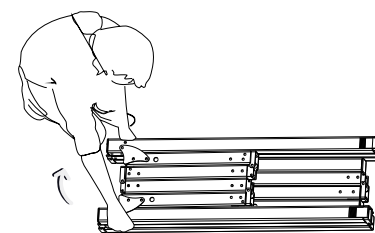

Picture 3

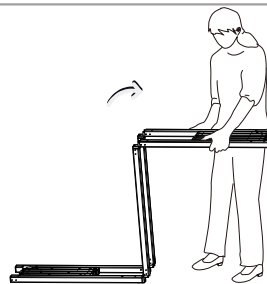

Picture 4

This projection screen should be installed at the best possible viewing position for the audience. Front projection (Fig. 1) and Rear projection (Fig. 2). Install according to material chosen.

1. Unpack and extend frame on a flat surface (Fig. 3 & 4).

Installation

2. To secure frame, "click" hinges into place (Fig. 5&6).

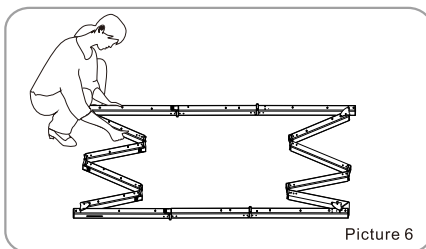
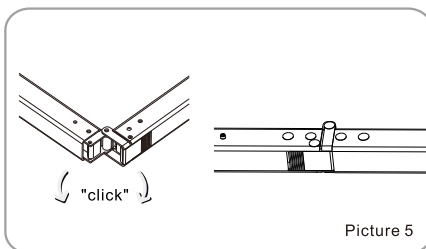

3. Make sure 4 corners are 90 degrees then secure with support beams (Fig. 7-9).

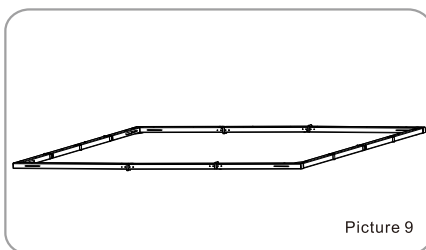
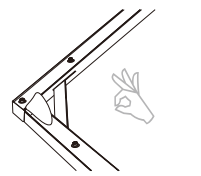
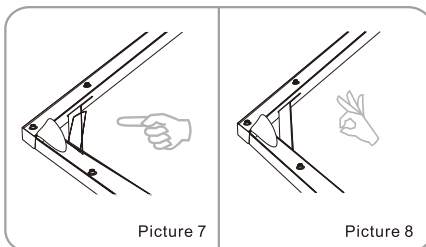

Disassembly

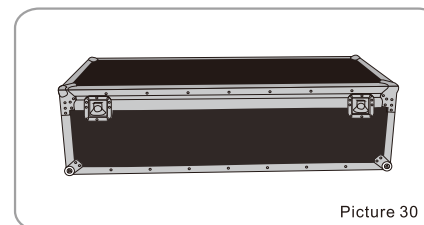

11. Store firstly frame and legs on the bottom layer of the freight case, fabric on top layer (Fig. 30).

Disassembly

1. Lay down the screen on flat ground (Fig. 24).

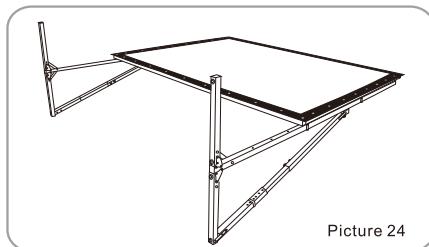

2. Take off screen from the frame by releasing the buttons then fold (Fig. 25).

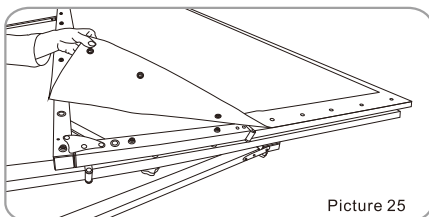

3. Screw off the black knobs and fold the legs with releasing the locking system (Fig. 26-27).

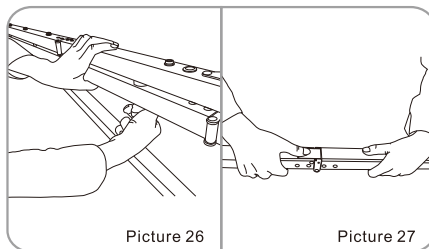

Picture 27

4. Release the support beam on frame corners (Fig. 28) as well as the locking buttons on the frame, then fold the frame from both sides (Fig. 29).

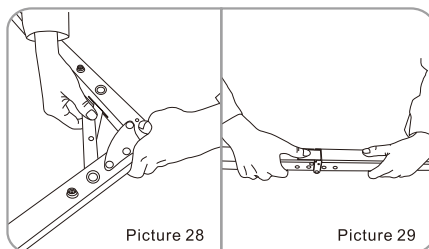

Picture 29

Installation

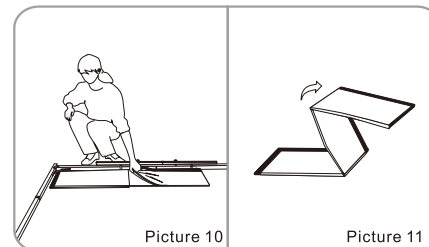

Picture 11

4. Unfold screen fabric and lay over frame (Fig. 10-11).

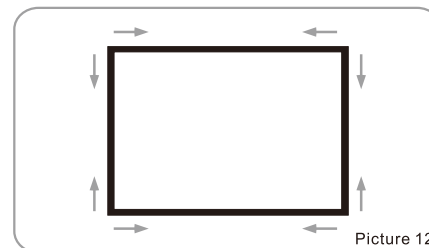

5. Snap screen buttons to frame. Start at top and finish at bottom (Fig. 12-15).

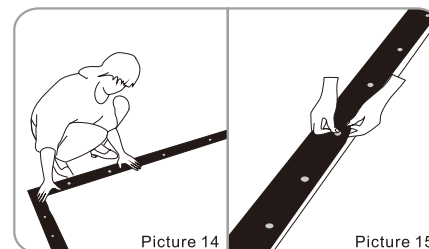
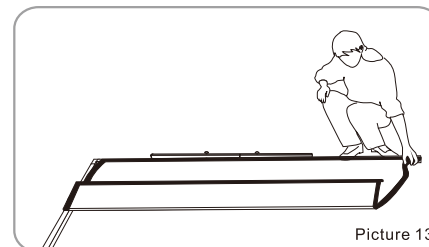

Picture 15

Installation

6. Unpack and extend legs (Fig. 16).

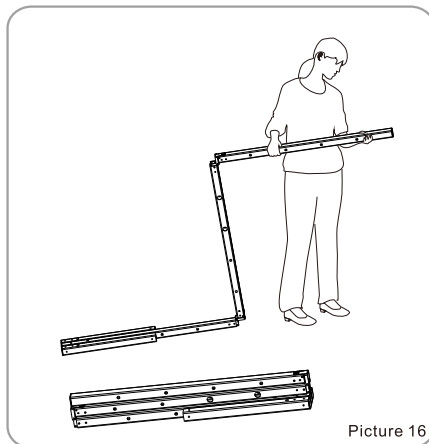

Picture 16

7. Set frame to desired height then extend legs accordingly and fasten with black knob (Fig. 17-19).

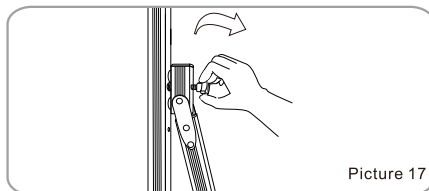

Picture 17

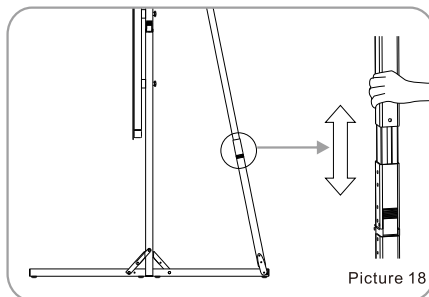

Picture 18

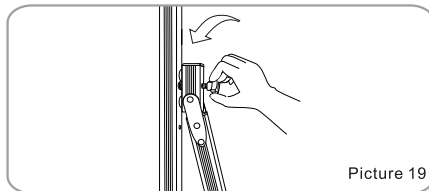

Picture 19

Installation

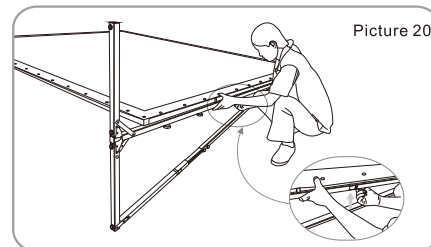

Picture 20

8. It's best to attach legs to frame on flat ground. When raising the screen, ensure Grandview logo and double-sided snaps (for masking custom masking-curtain) are on bottom (Fig. 20 & 21).

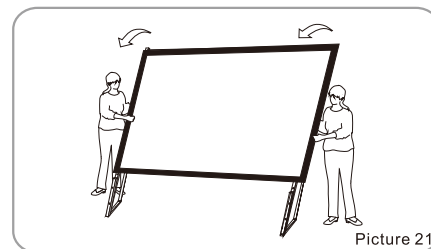

Picture 21

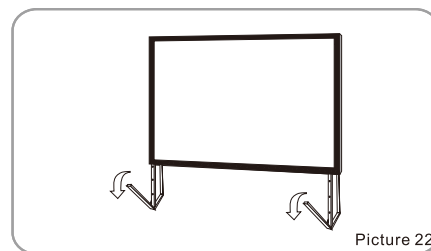

Picture 22

9. Pull down front feet for stability (Fig 22 & 23).

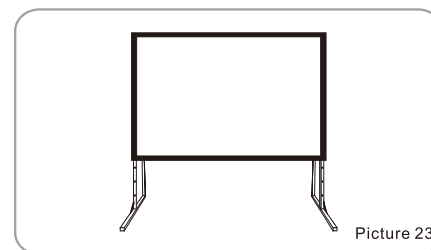

Picture 23