

Ordinary electric screen (M) manual control mode:

Screen manual control switch (Figure 1)

Open the screen (Fig. 2): Press the “=” position of the control switch, the screen will automatically drop, and the lower limit will stop automatically.

Retract the screen (Fig. 3): Press the “—” position of the control switch, the screen will be automatically recycled, and the upper limit will stop automatically.

Stop the screen operation: To stop the screen operation, place the control switch at the center point “●” and the screen stops.



Figure 1

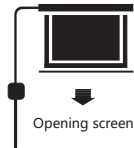

Figure 2

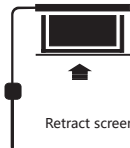
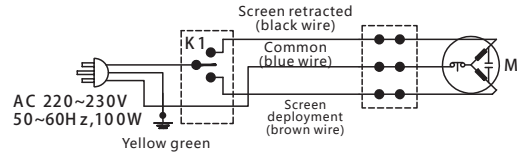

Figure 3



Adjustment method for screen recovery height (upper limit position) and unfolding height (lower limit position):

If it is necessary to adjust the limit height due to the installation environment or the limitations of the site.

The upper and lower limits can be adjusted by adjusting the motor positioner inside the lower left of the screen by the motor positioning adjustment tool. As shown below:

Note: When the screen recovery height is adjusted beyond the upper limit, the screen will automatically drop. In this case, please press stop (can be controlled by manual/transmitter), and the green knob can be rotated clockwise to fine tune.

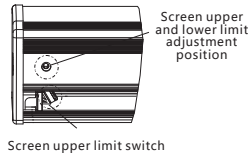

Screen upper limit switch

Green knob  
Recovery height (upper limit) ↑

⌚ Clockwise adjustment:  
move down  
⌚ Counterclockwise adjustment:  
move up

Yellow knob  
Expand height (lower limit) ↓

⌚ Counterclockwise adjustment:  
move up  
⌚ Clockwise adjustment:  
move down

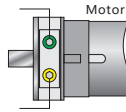

Note:

Please be careful. When adjusting the recovery height, prevent the screen from being caught too much and cause the motor and screen to be damaged. When adjusting the unfolding height, the height of the black edge on the screen can only be increased within 10cm, otherwise the screen will fall off easily;

Electrical Screen parameters:

voltage AC 220-230V/50-60Hz, current 0.5A, power 100W.

RF remote (F): Voltage 3V, use CR2032\*2 battery;

Radio Frequency: 868MHz

IR remote: Voltage 3V, use CR2032 battery

# Grandview

## Maintenance

In order to maintain good performance of screen, please cover the screen with cloth if it is not used for a long term to prevent dust and dirt from screen. If there are apparent varies or dirt on screen material, please use soft brush or cloth to clean it.

## Clean the screen material

Rub gently according to grain of velvet frame with warm water mixed with soft detergent. (Please be noted that it should be gently rubbed instead of scrubbing hard). Please prevent from hitting the frame in case of damage of velvet. By finishing cleaning, let frames dry itself.

Please do not use any dissolvent, chemical agent or any tool with strong friction for clean, which would cause permanent damage to the screen.

# Grandview



## Legacy Tab Tension Series Product Manual

Wire- controlled electric screen  
Intelligent electric screen

Applicable Model:

LE - M  
LE - MI  
LE - MF

## Guangzhou Grandview Creative Technology Co., Ltd

Add: No.1 Building of No.43 South International Trade Avenue, HualongTown,  
Panyu District, Guangzhou China.

Tel: +8620-8489-9499 Fax: +8620-8480-5299

Web: www.grandviewscreen.com



## Respected user:

Thank you for purchasing the Grandview Legacy series projection screen. Please read the manual carefully before use. Please read the collection after reading for future reference!

## Installation preparation

### Installation Accessories

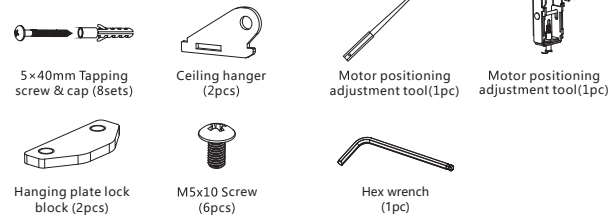

### Wall/top mounting

Install the mounting bracket on a wall/ceiling of sufficient weight and keep the same horizontal line from both ends of the screen casing (10 cm from both ends), as shown on the right:

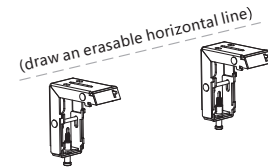

Loosen the locking screw and lower the locking block to the minimum. Figure:

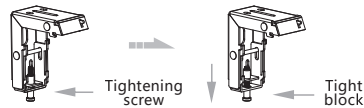

The top ends of the screen casing are horizontally attached to the top of the mounting bracket and pushed into the mounting bracket, so that the top slot is buckled into the top slot of the mounting bracket, and the latch pushed into the mounting bracket makes a sound, indicating that the screen has been securely buckled into the installation. Frame, locking screws, fixed screen. Figure:

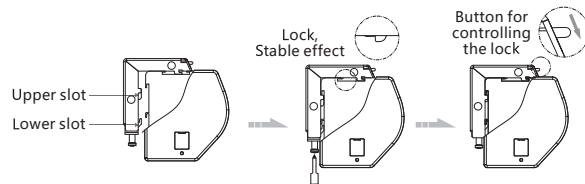

Note: When removing the screen, loosen the screw at the bottom of the mounting bracket, press down on the button on the top of the mounting bracket and remove the screen, as shown above.

### Suspension installation

Insert the hanging plate lock block into the square hole of the hanging plate, then pass the inside and outside through the hanging plate slot, and then align it with the screw hole. As shown

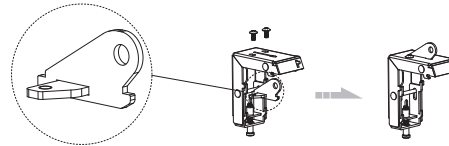

Refer to the wall mount/top mounting method to determine the installation distance and position, and connect the screen housing to the mounting bracket.

Depending on the required mounting height, the hook/steel is attached to the ceiling and finally connected to the hole in the hanging plate on the screen. As shown

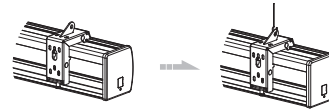

### Tension device instructions

Grab the lower pole and use M3 hex wrench to push and twist the hex axis in Clockwise direction to adjust the tab tension. until it's adjusted to the proper position.

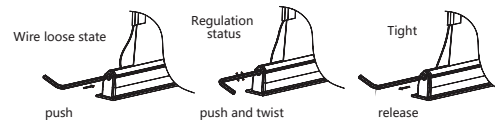

### Precautions

Before you officially launch the screen, be sure to clear all the stickers that connect the bottom bar and the bottom of the screen.

### Important matters

Before installation, be sure to check the installed position (ceiling or wall) and the suspension device can withstand loads above 25KG, otherwise accidents may occur.

This product uses a single-phase AC power supply. It must be connected to a socket with a ground wire and the grounding is good.

This product uses a single-phase AC power supply. It must be connected to a socket with a ground wire and the grounding is good.

### Connect the power supply

The Grandview projector screen is equipped with a standard power plug, so you can easily plug the plug into the socket and your screen will be ready for use.

### Screen control function description Intelligent electric screen has 4 kinds of control methods:

- A. Manual control (cycle button)
- B. Infrared control or wireless control
- C. Dry contact control
- D. RS485 or RS232 control

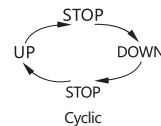

Use the screen control port. Need to completely open the end cap.

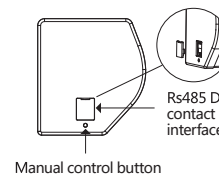

### A Manual control

The manual control button is at the left end of the screen housing (near the Rs485 and dry contact interface). This button is a cyclic control button.

### B. -MI for IR: AC127 / -MF for RF: AC123

- UP : screen UP
- STOP: screen STOP
- DOWN: screen DOWN
- Mirco-up: retract the screen in small increment
- Mirco-down: lower the screen in small increment
- IR: transfer signal by IR (Wavelength: 940Nm)
- RF: Pre-set in factory; transfer signal by Radio wave(868MHz).

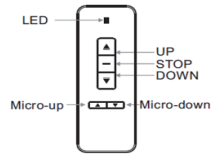

### Programming code setting:

Screen connects to power within 10 seconds (in programming mode), press the UP & STOP buttons together on the remote. Pairing completed.

### Programming code Clearing:

Screen connects to power within 10 seconds (in programming mode), press the UP & STOP buttons together on the remote. Clearing completed.

### C Dry contact control

The control output port is connected to the RJ45 plug. From the left, 4, 5, 7, and 8 are control lines.

Line number	4	5	7	8
Function	Public	Down	Stop	Up

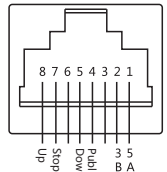

### D RS 485 or RS 232 control

The control output port is connected to the RJ45 8P8C plug. From the left, the 1 and 2 lines are the control lines, and the RS485 control is connected. The 1 line is D- and the 2 line is D+. The Rs232 control connection is as shown:

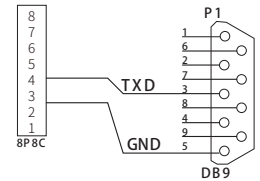

### RS 485/RS 232 port settings

Bit rate:  
Data bit: 8 digits  
Parity: none  
Stop position: 1

### Hexadecimal control code

UP: ff ee ee dd  
STOP: ff ee ee cc  
DOWN: ff ee ee ee  
Part of the central control should set the address code: ff ee ee aa

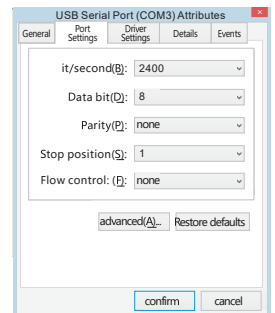

### Note

When connecting to RS232 or RS485, if there is control that does not control the screen, please reverse the two control lines. Wiring loop resistance is less than 20Ω Cannot be routed in parallel with strong interference sources.